

Magnetic  
NORTHVAN

DISCOVER YOUR PATH  
at the new  
Harry Jerome  
Community  
Recreation  
Centre  
TO WELLNESS

Harry Jerome Community Recreation Centre

# EMERGING CONCEPT DESIGN

## Council Presentation

March 12, 2018



March 12, 2018

city  
of north  
vancouver

NORTH VANCOUVER  
Recreation  
& Culture

HCMA  
Architecture  
Design

Harry Jerome Community Recreation Centre

## Emerging Vision

“

The Harry Jerome Community Recreation Centre will be a welcoming, vibrant, social heart of the community.

It will foster individual and collective wellness by providing opportunities to participate in a variety of organized and casual activities.

A beacon of pride in the community, the centre will reflect the unique identity and character of North Vancouver.

”

# Principles

## THE HARRY JEROME COMMUNITY RECREATION CENTRE WILL BE...

01

Accessible to all, with freedom and opportunity to participate in a variety of casual and structured activities.

**Equity**

02

An inclusive place that draws people together and fosters strong social connections between the diverse communities of North Vancouver.

**Social Inclusion**

03

A welcoming and safe environment that clearly communicates it's okay to be who you are, and promotes ease of use.

**Secure**

04

Responsive to evolving community needs which creatively shape a broad range of recreation and cultural activities.

**Adaptable**

05

Supportive of individual and community wellness through physical, social, and creative pursuits. A connection to the natural environment is deeply valued in achieving this.

**Wellness**

06

A global example of social and environmental sustainability and resilience.

**Environmental Sustainability**

# Graphic Facilitator's Interpretation of Community's Vision



March 12, 2018

city  
of north  
vancouver

NORTH VANCOUVER  
Recreation  
& Culture

HCMA  
Architecture  
Design

Harry Jerome Community Recreation Centre

# Community & Stakeholder Engagement



A place to meet other community members and enjoy spending time with others.

It should be welcoming and inclusive for anyone that wants to come use the facility.

Space to engage both my kids at the same time with a variety of options, such as pottery studio, climbing wall, art, music, skating and swimming.

We heard from

**895** COMMUNITY MEMBERS

via an online survey.

And multiple

STAKEHOLDER GROUPS

The top 3 spaces community members anticipate using at least once a week are:

COMMUNITY & SOCIAL SPACES

60%

AQUATICS SPACES

60%

FITNESS & RECREATION SPACES

51%

# Regional Context



March 12, 2018



Harry Jerome Community Recreation Centre

# Local Context

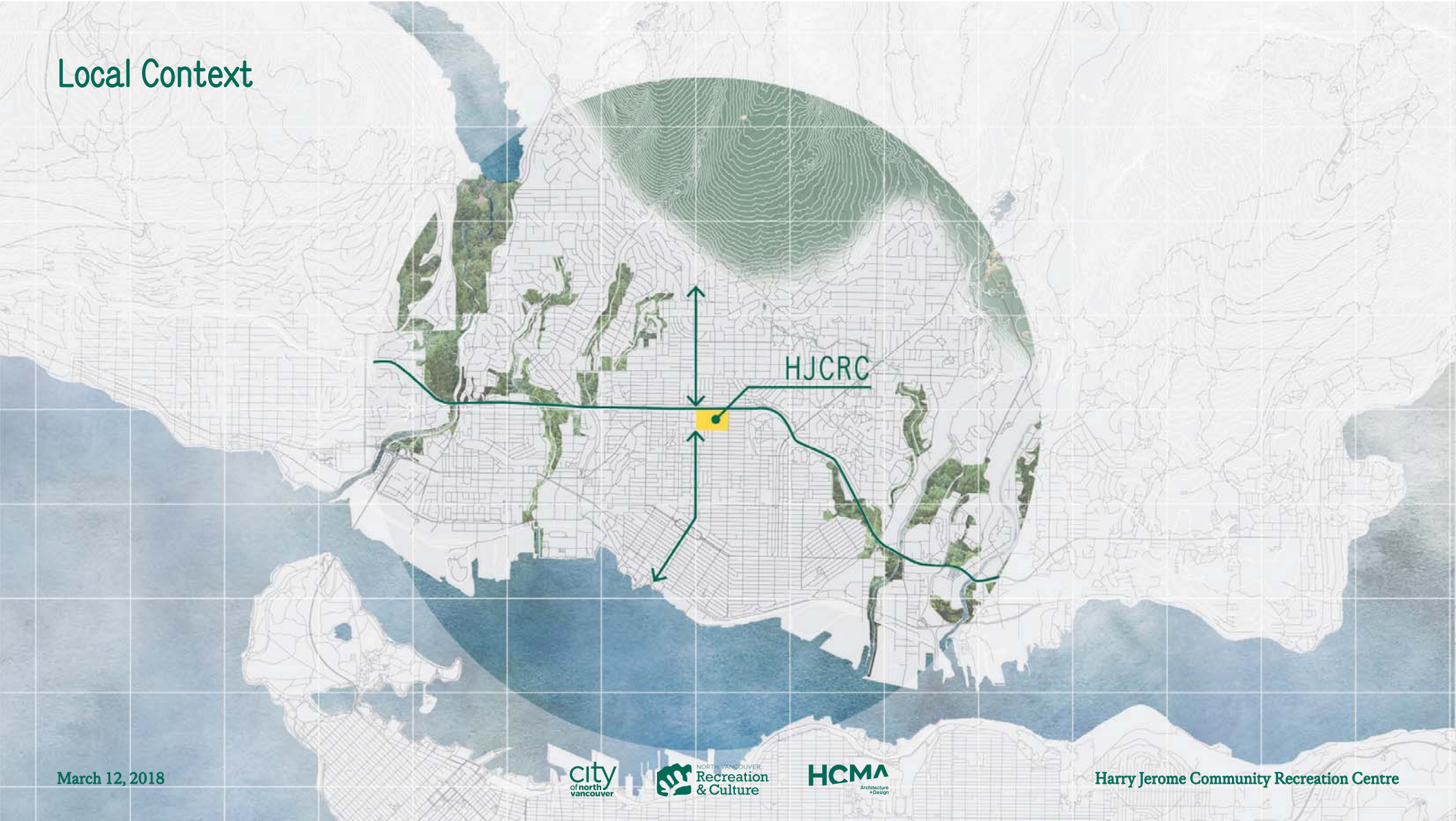

March 12, 2018



Harry Jerome Community Recreation Centre

# Local Context



March 12, 2018



Harry Jerome Community Recreation Centre



Project Site

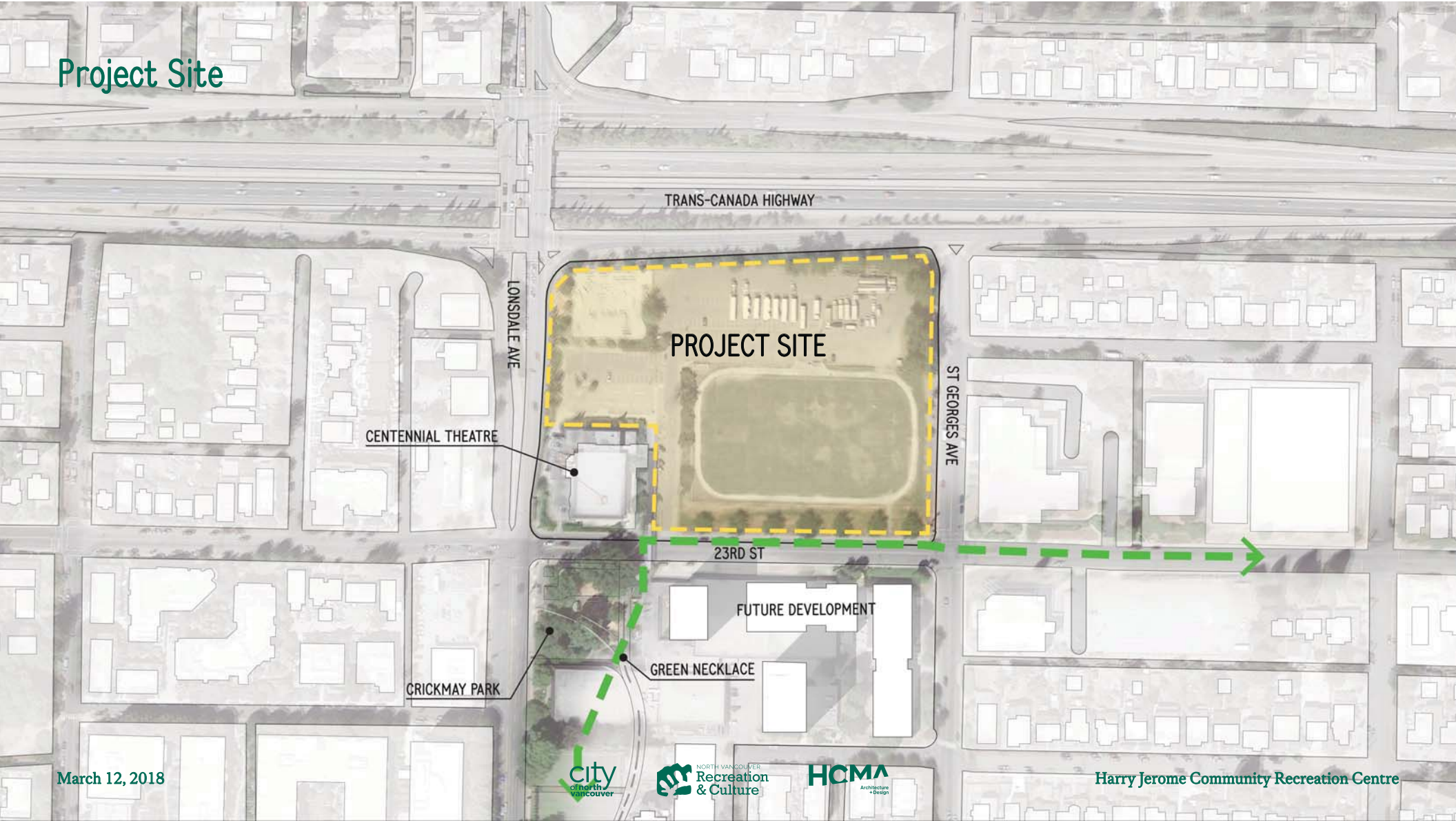

TRANS-CANADA HIGHWAY

PROJECT SITE

LONSDALE AVE

ST GEORGES AVE

CENTENNIAL THEATRE

23RD ST

FUTURE DEVELOPMENT

CRICKMAY PARK

GREEN NECKLACE

March 12, 2018



Harry Jerome Community Recreation Centre

# Views + Experiences of North Vancouver

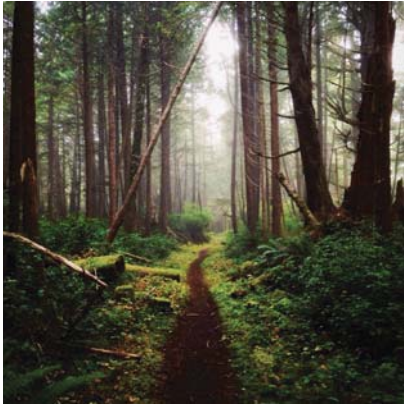

March 12, 2018



Harry Jerome Community Recreation Centre

# Views + Experiences of North Vancouver

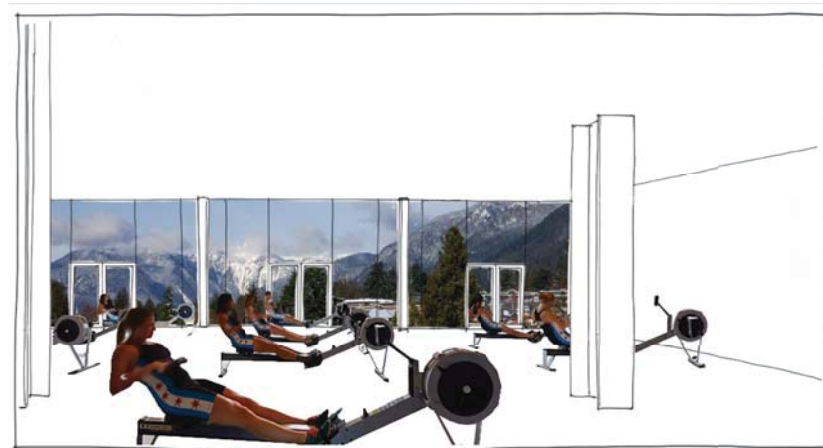
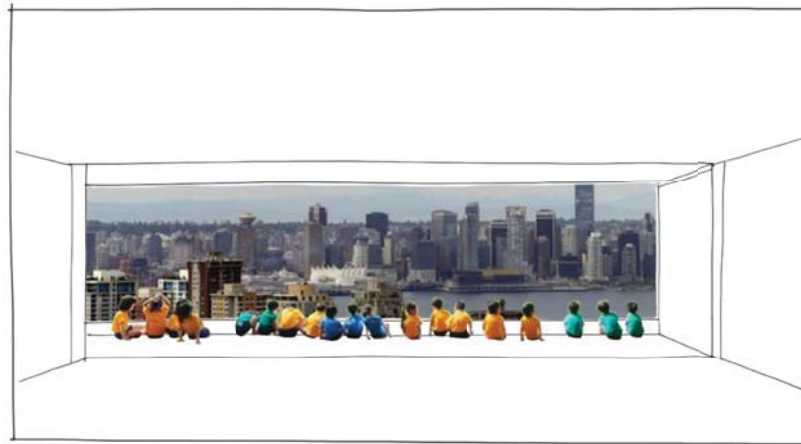

March 12, 2018



Harry Jerome Community Recreation Centre

# MASSING DIAGRAM

- Building Massing

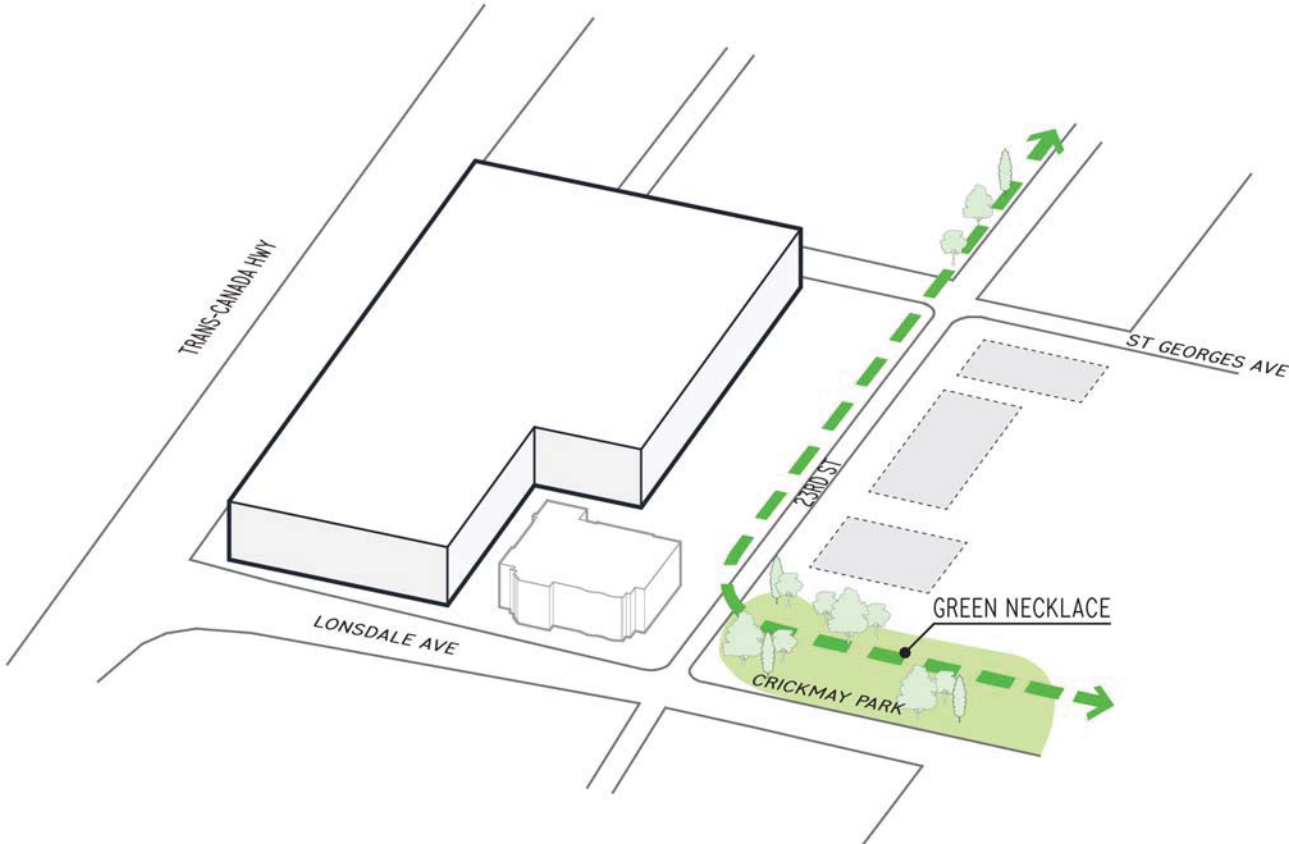

## MASSING DIAGRAM

- Break Open Massing to Allow:
  1. Views
  2. Daylight
  3. Natural Ventilation
- Locate Large Program areas next to highway
- Locate Larger Blank Walls Next to Steep Slopes
- Maximize Parking Efficiency

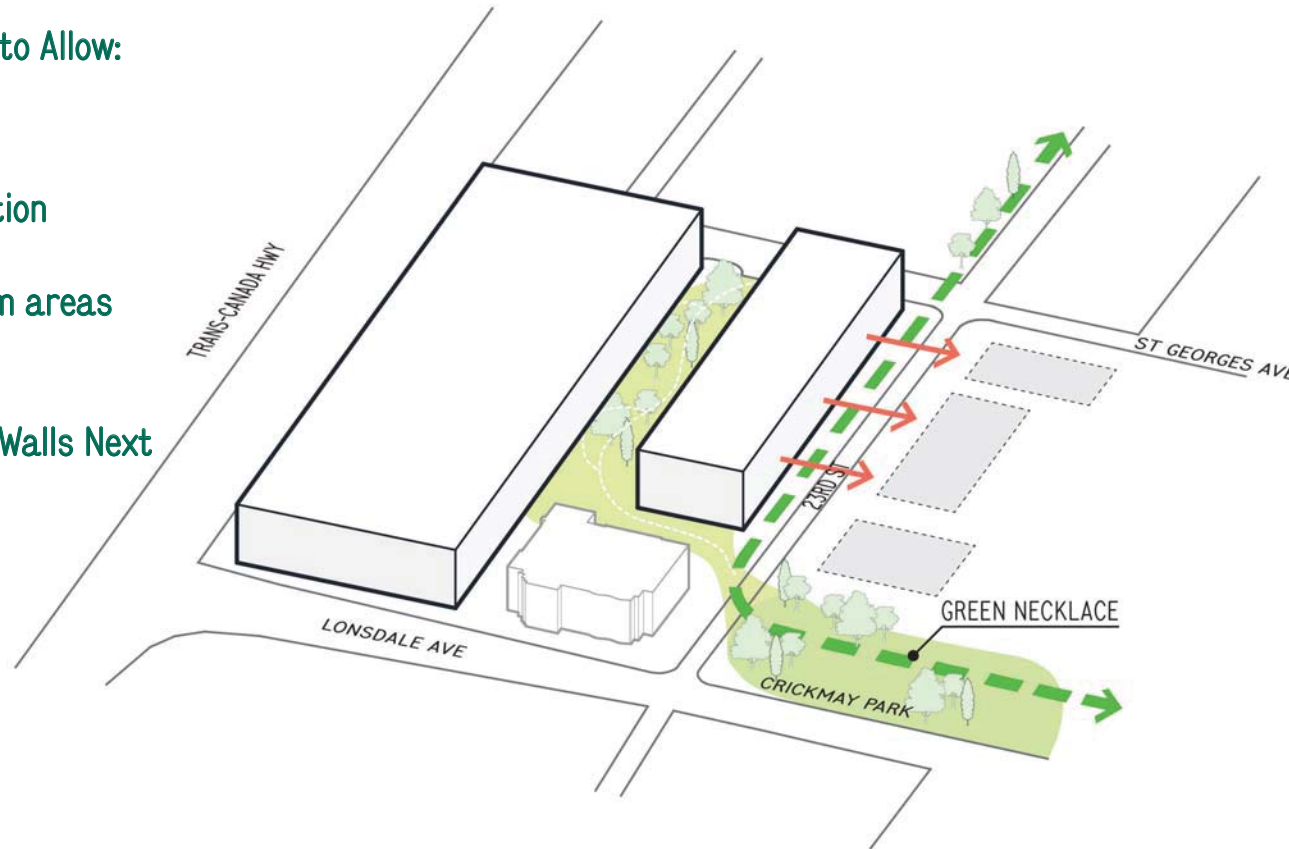

## MASSING DIAGRAM

- Break Down Massing to Establish Neighbourhood Scale on 23rd St.
- Connect Internal and External Green Corridors

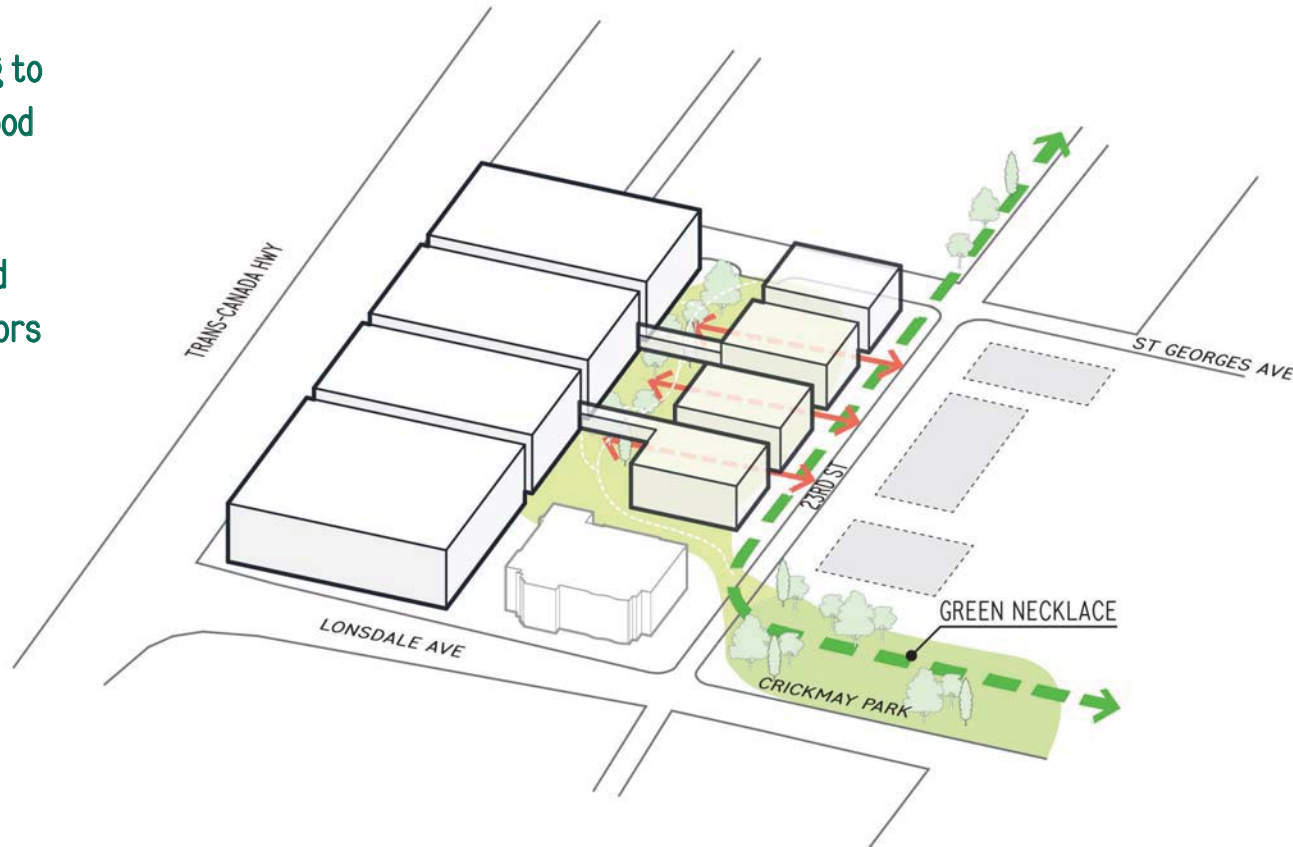

## MASSING DIAGRAM

- Maximize Transparency at the Ground Plane
- Provide Covered Area for Youth Zone
- Establish Key Social Spaces as Anchors to Green Corridor

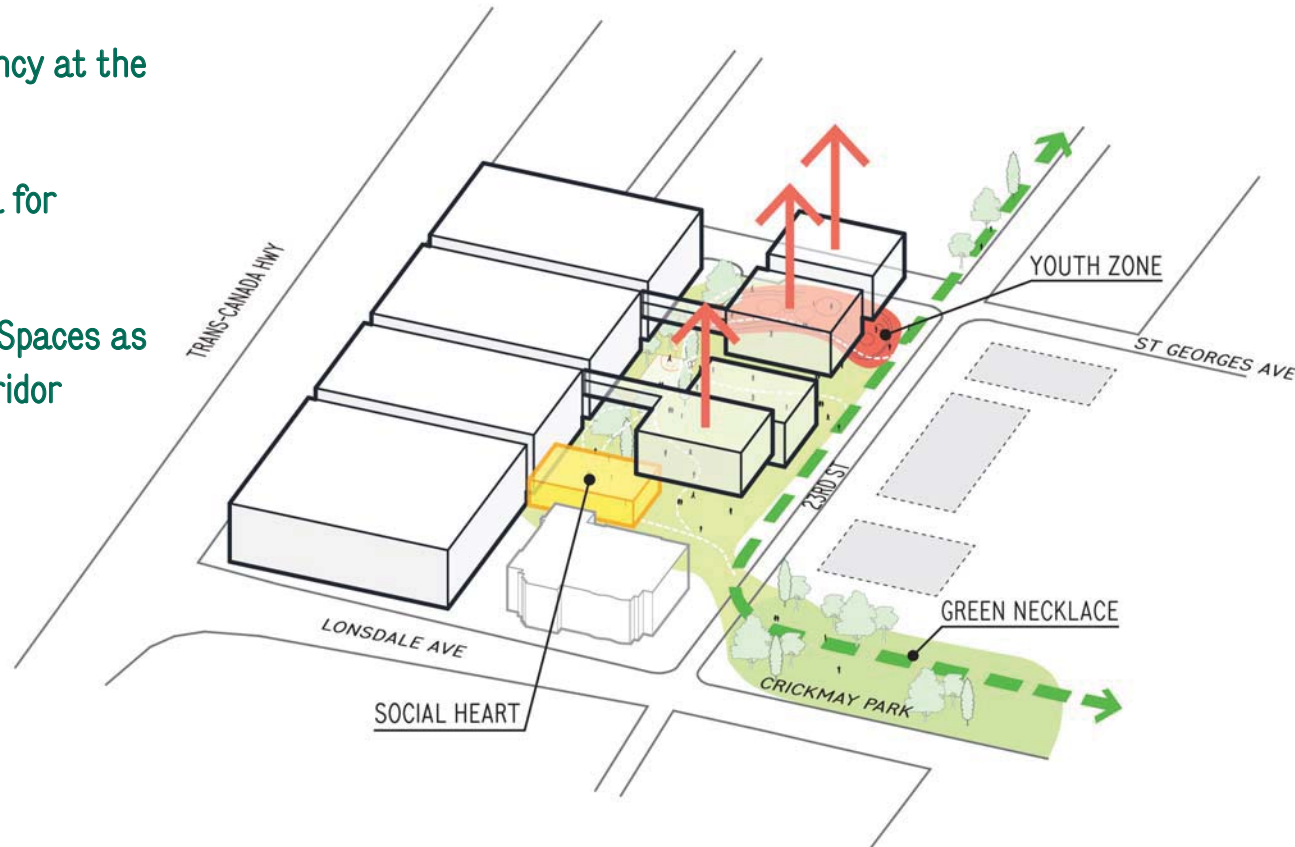

# MASSING DIAGRAM

- Establish Visual Connections to Mountains + Ocean

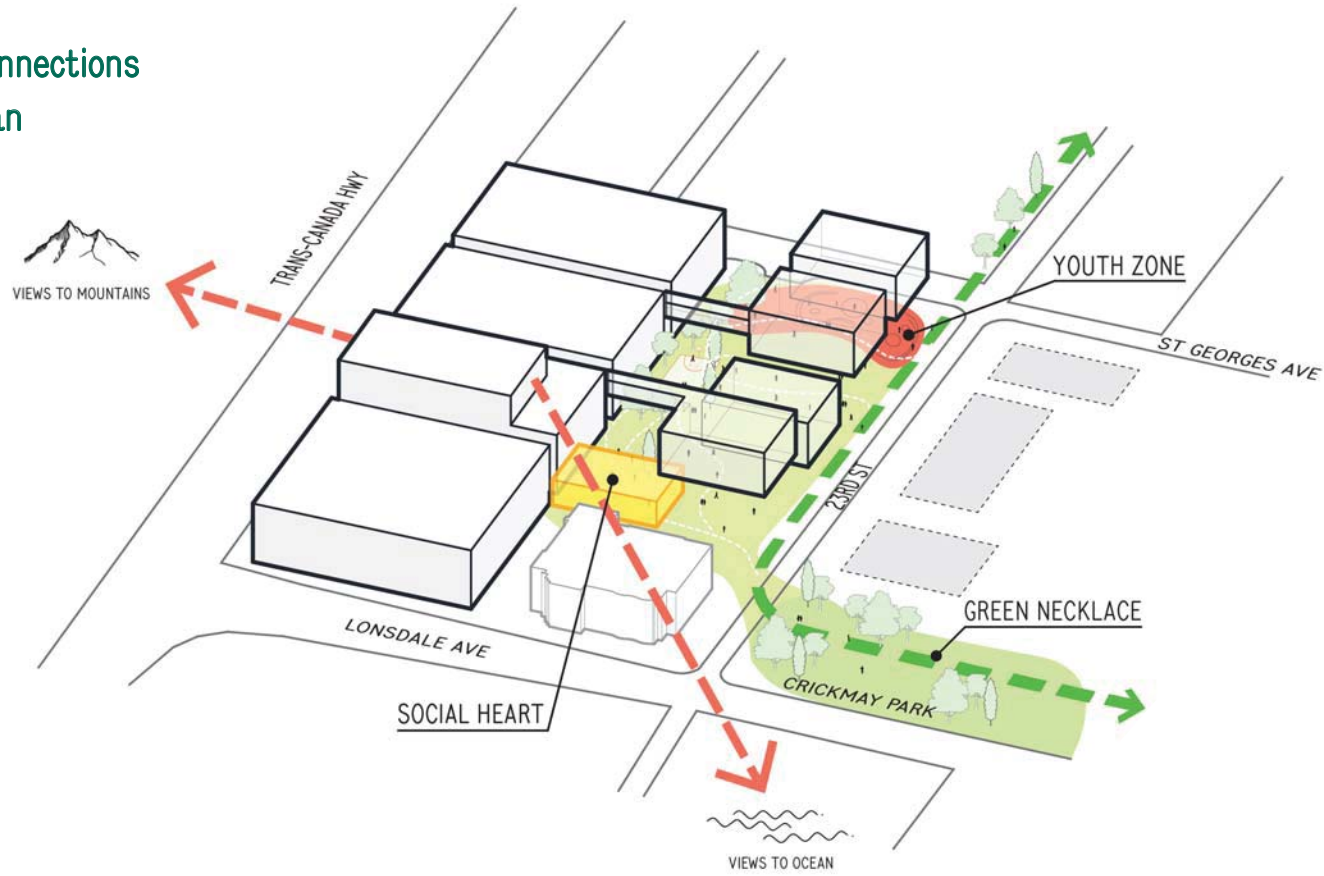



# Level -1

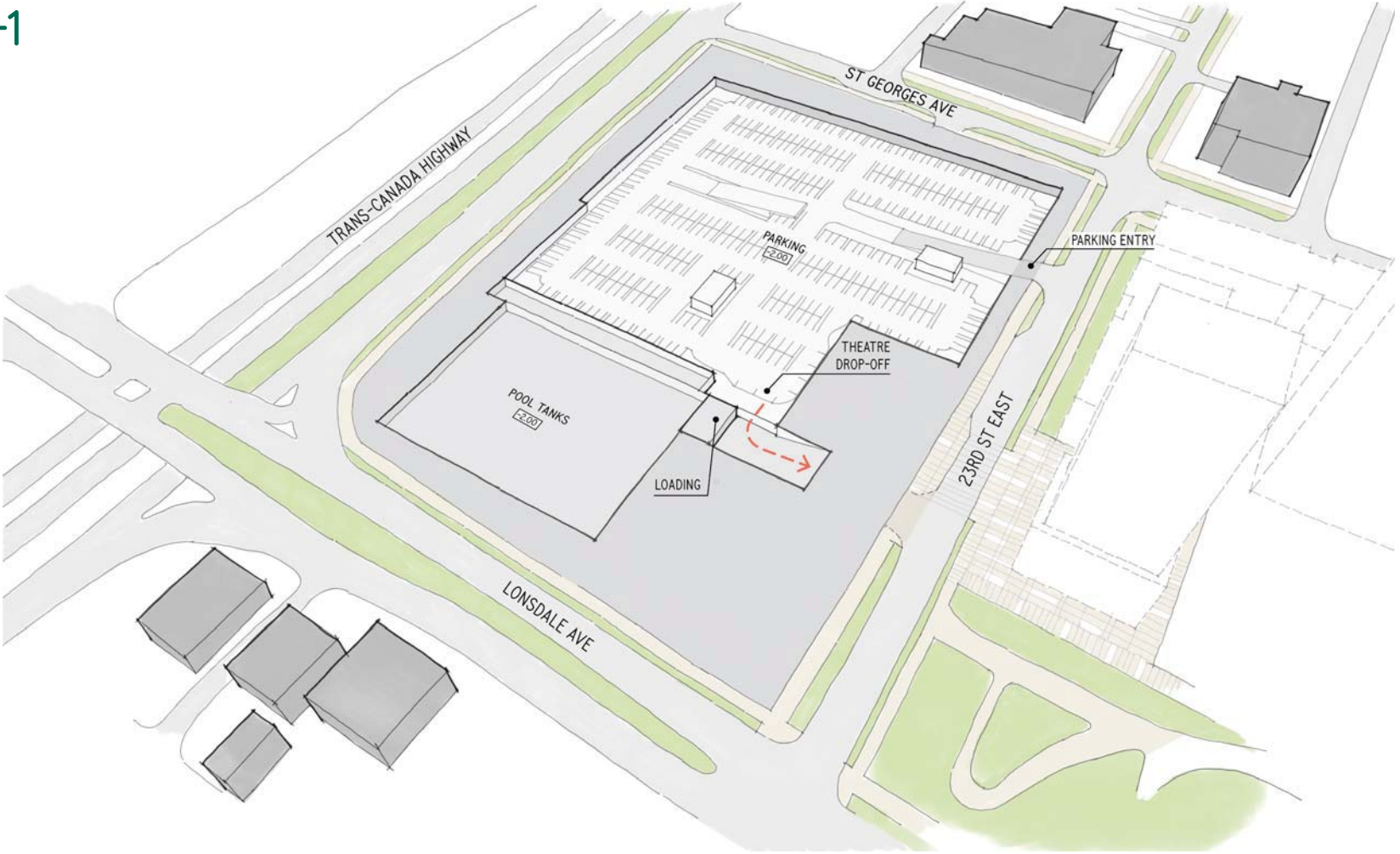

March 12, 2018



Harry Jerome Community Recreation Centre

# Ground Floor

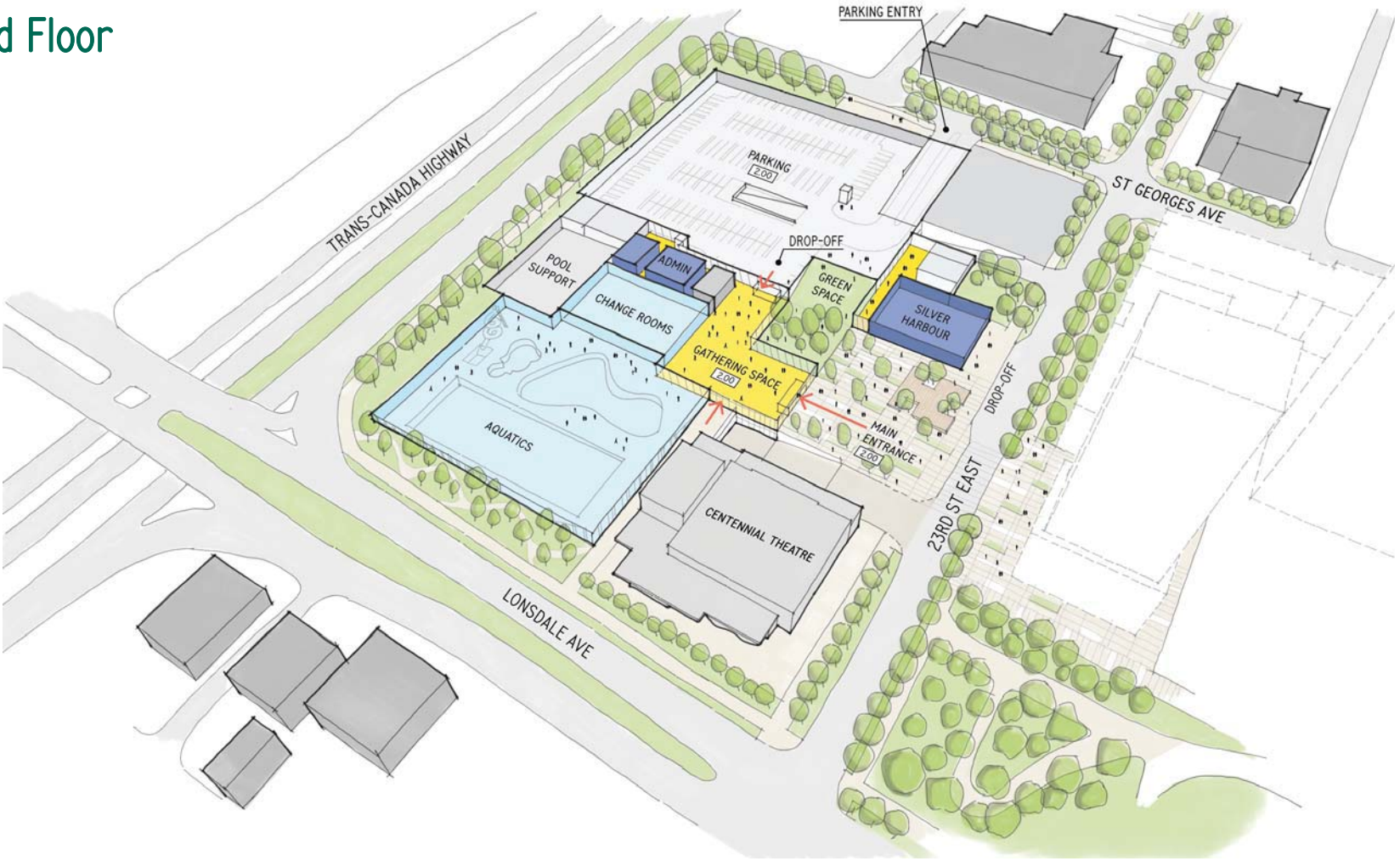

March 12, 2018



Harry Jerome Community Recreation Centre

# Level 2

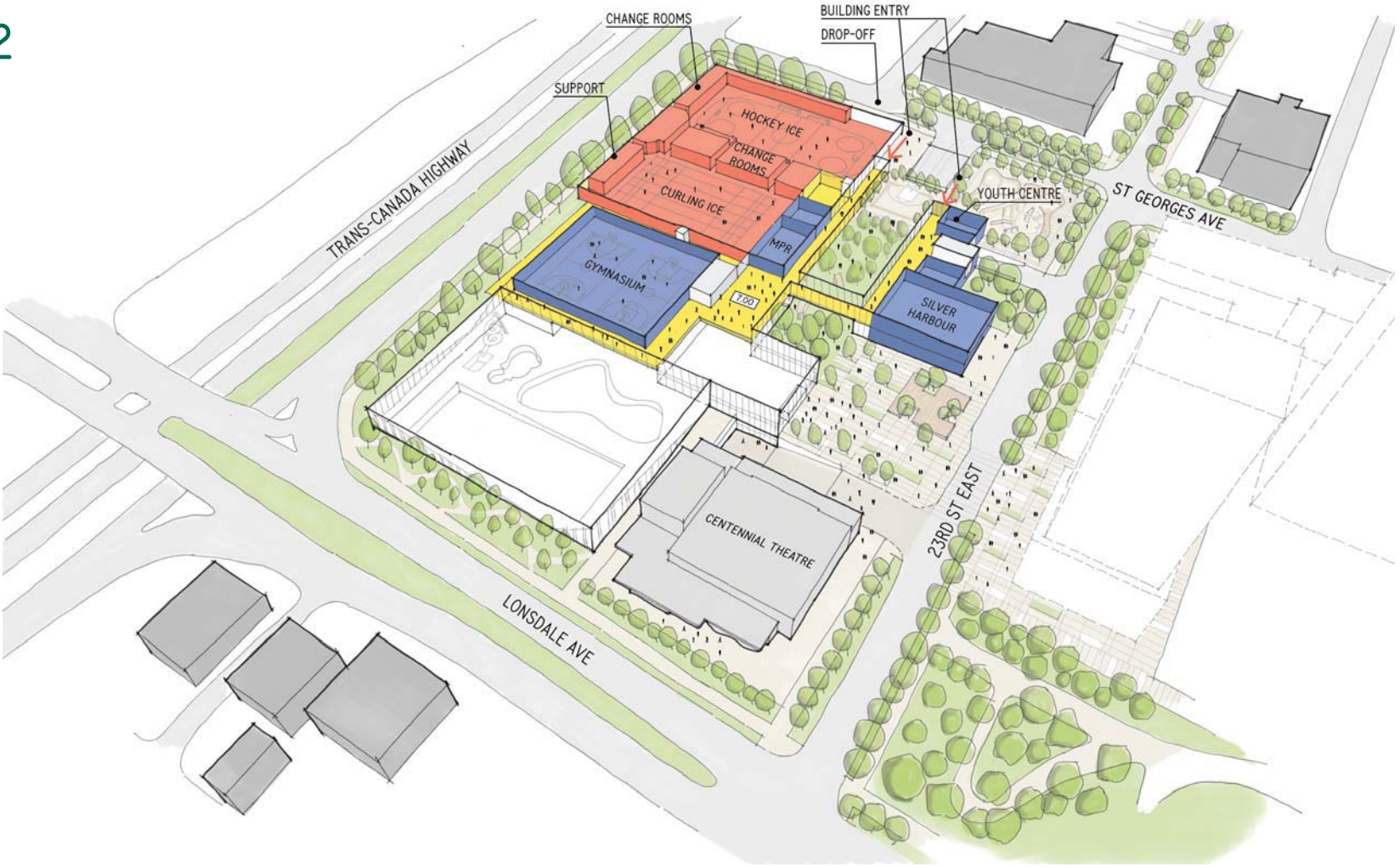

March 12, 2018



Harry Jerome Community Recreation Centre

# Level 3

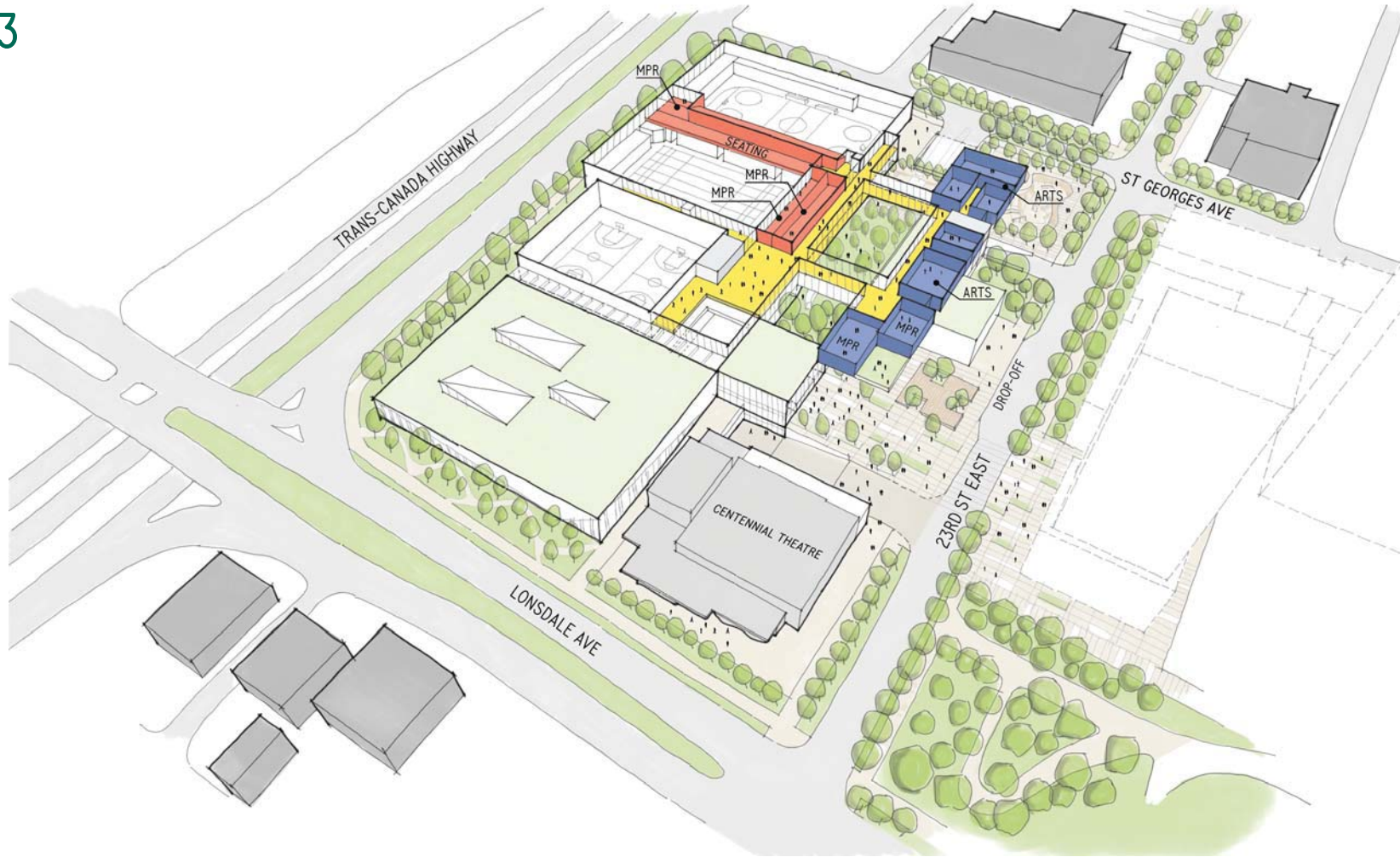

March 12, 2018



Harry Jerome Community Recreation Centre

# Level 4

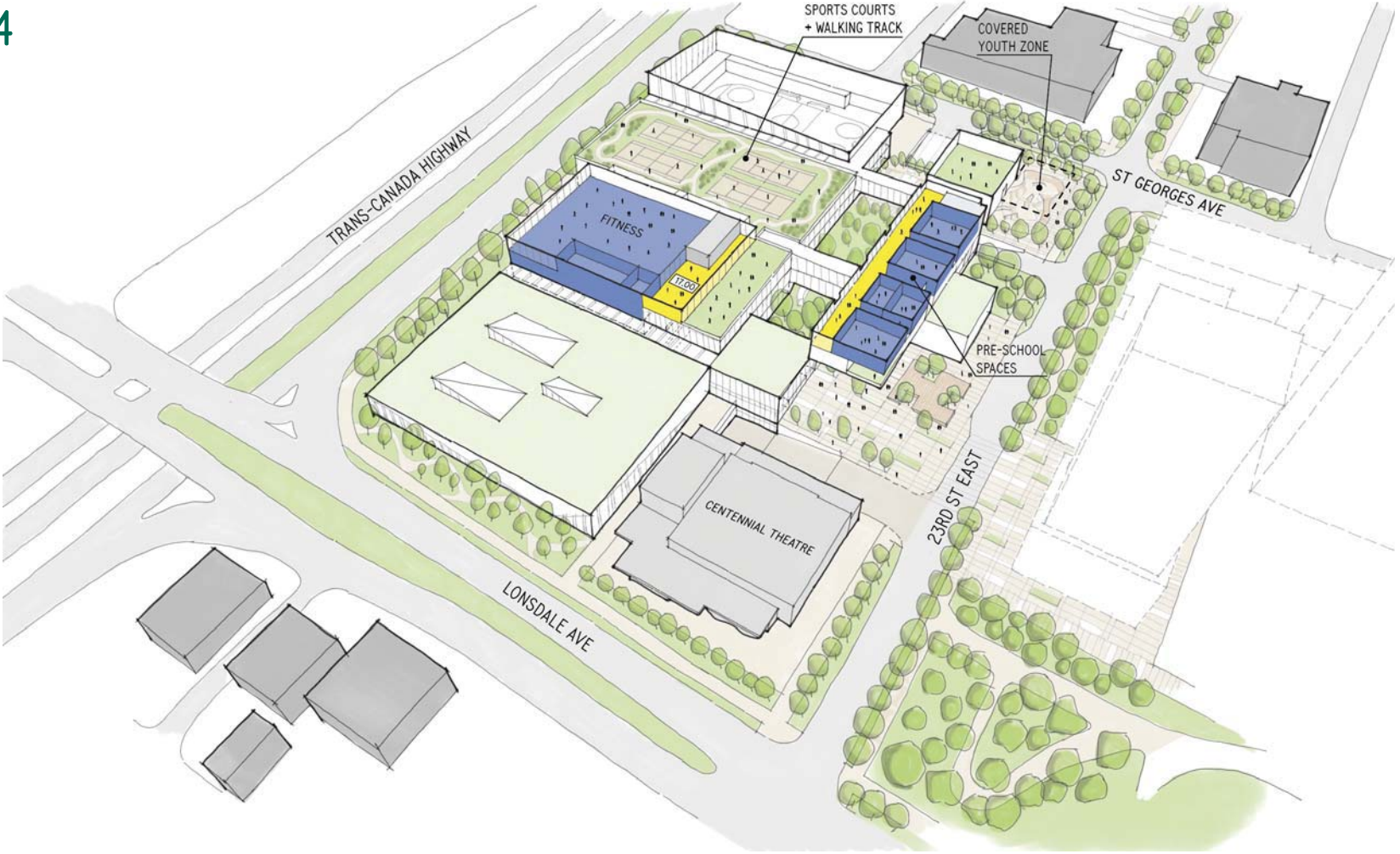

March 12, 2018



Harry Jerome Community Recreation Centre

# Aerial View

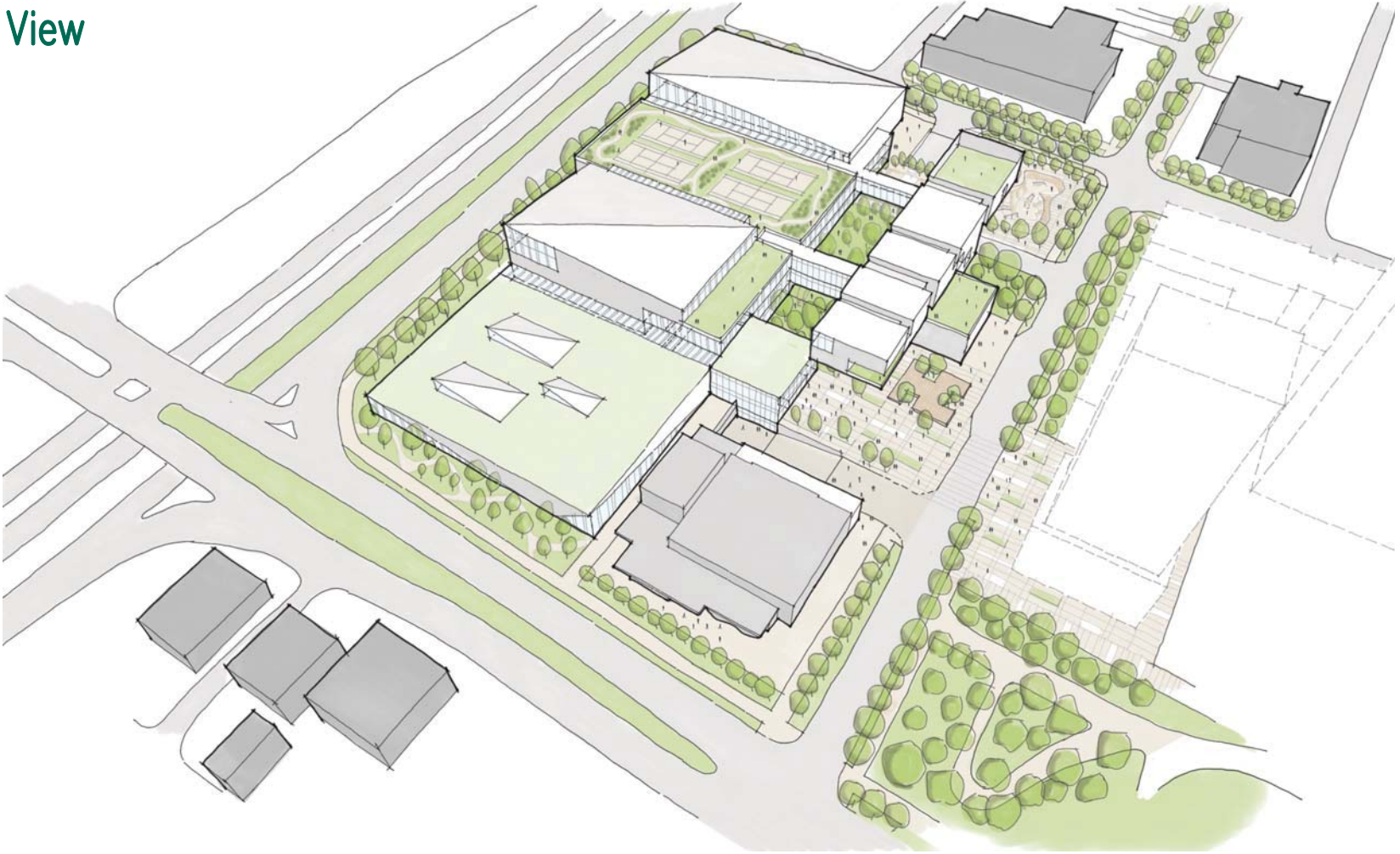

March 12, 2018



Harry Jerome Community Recreation Centre

## Youth Zone

- Skatepark
- Courts
- Social Space
- Lounge
- Active Green Space

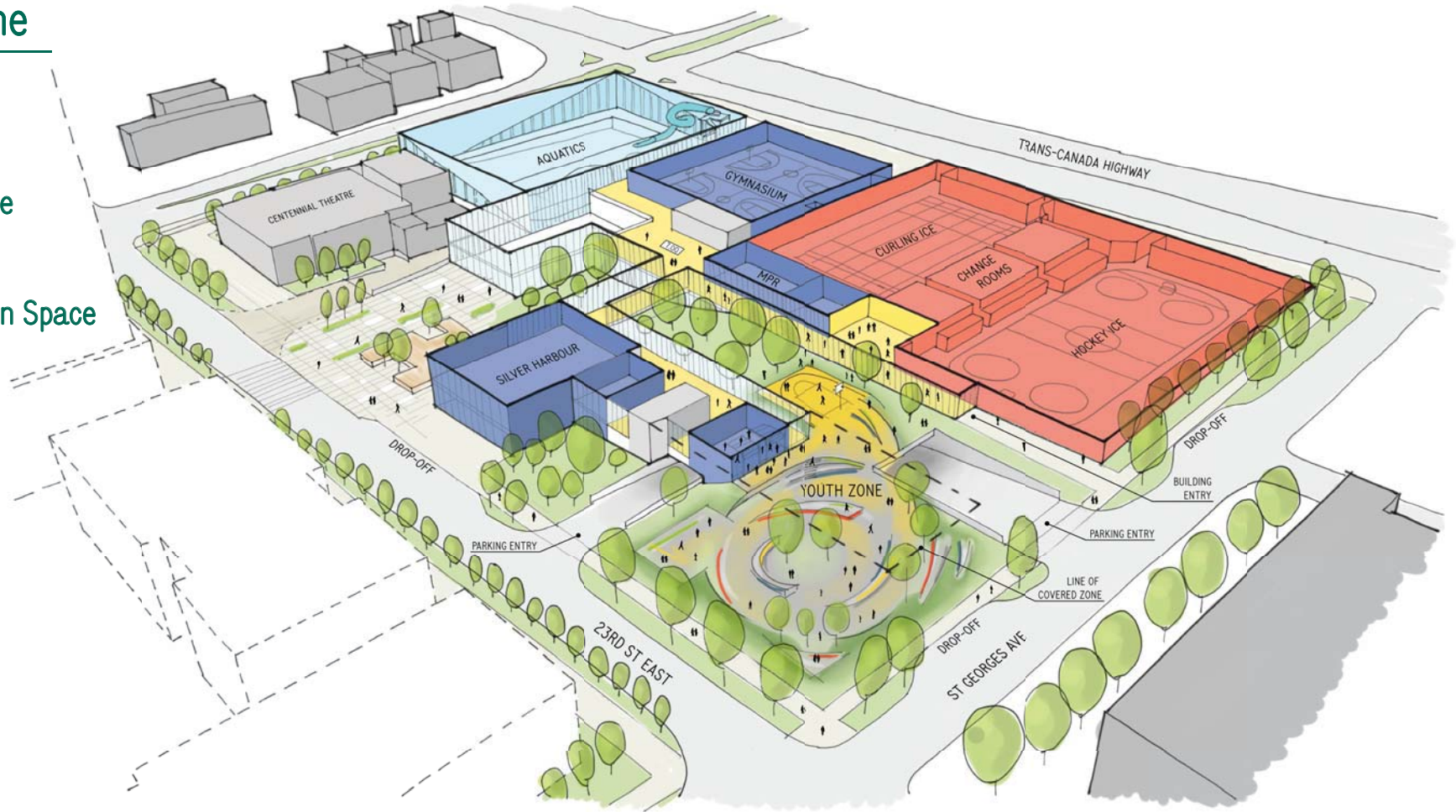

March 12, 2018



Harry Jerome Community Recreation Centre

# View Opportunities From Site - Proposed Upper Level

Mountain Views

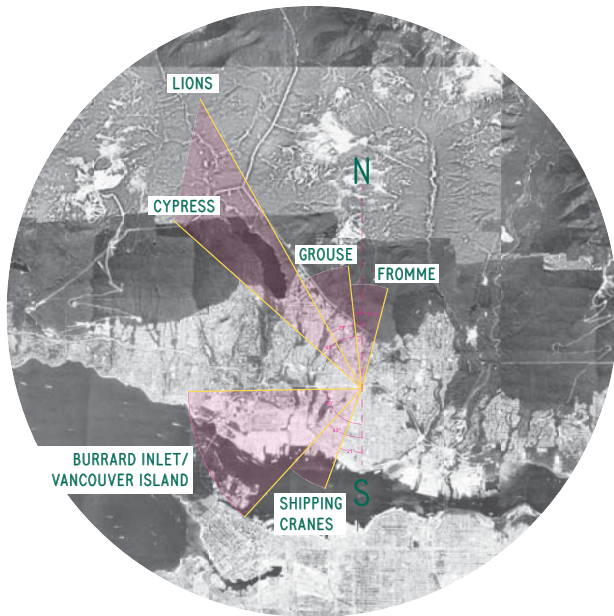
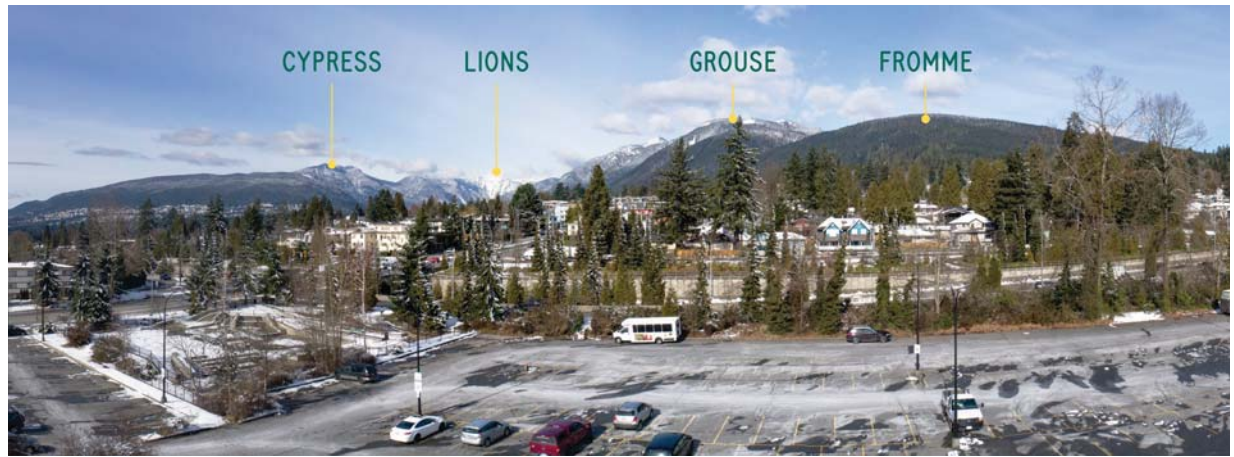

Ocean Views



March 12, 2018



Harry Jerome Community Recreation Centre



# Social Spaces



March 12, 2018



Harry Jerome Community Recreation Centre

# Recreation Spaces



March 12, 2018



Harry Jerome Community Recreation Centre

# Green Spaces



March 12, 2018



Harry Jerome Community Recreation Centre

# Indoor / Outdoor Youth Zone



March 12, 2018



Harry Jerome Community Recreation Centre

# Next Steps ...

